

**CHASE TOWER**  
333 W. HAMPDEN AVENUE  
ENGLEWOOD, CO 80110



**\$18.50—\$19.50 Full Service Rate**

**Full service lease rate—all expenses included**

**Suite 300**  
**1,372 sf**

**Four offices, conference room.**

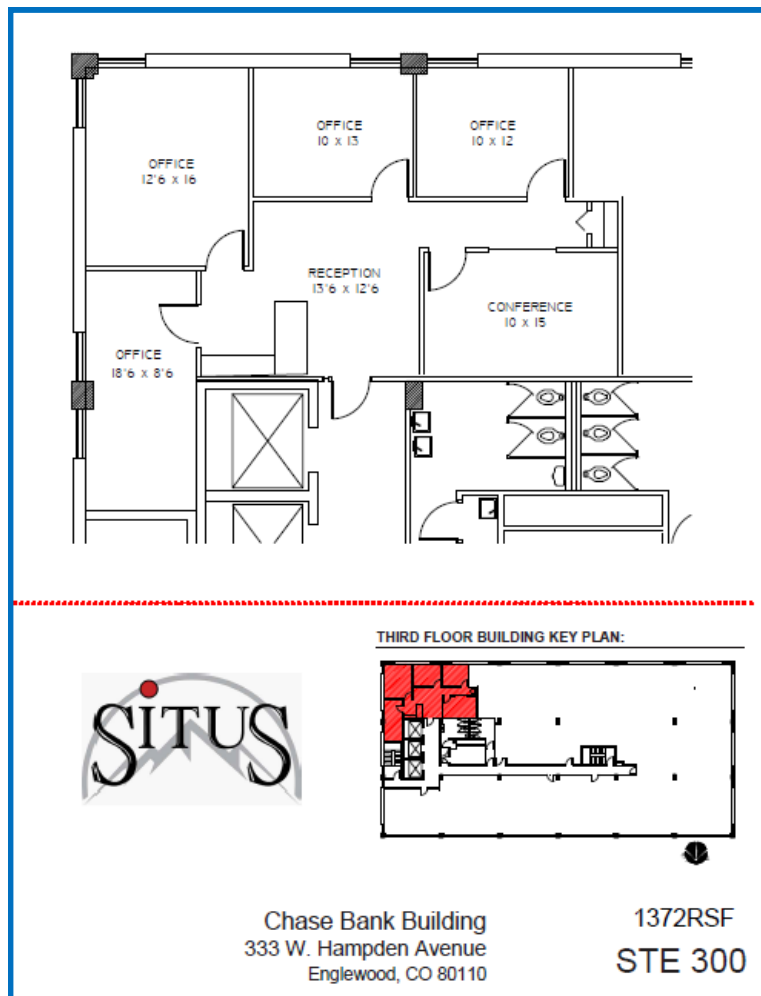

No warranty or representation is made as to the accuracy of the foregoing information.  
Terms of sale or lease and availability are subject to change or withdrawal without notice.

**FOR MORE INFORMATION, PLEASE CALL:**

**John V. Propp, CCIM—303/692-1816**  
**6565 S. Dayton St., Suite 3000**  
**Greenwood Village, CO 80111**

**learn more at [www.JohnProppCommercial.com](http://www.JohnProppCommercial.com)**



## CHASE TOWER

333 W. HAMPDEN AVENUE  
ENGLEWOOD, CO 80110



**\$18.50—\$19.50 Full Service Rate**

**Full service lease rate—all expenses included**

**Suite 415  
1,304 sf**

**Four offices, reception, break room.**

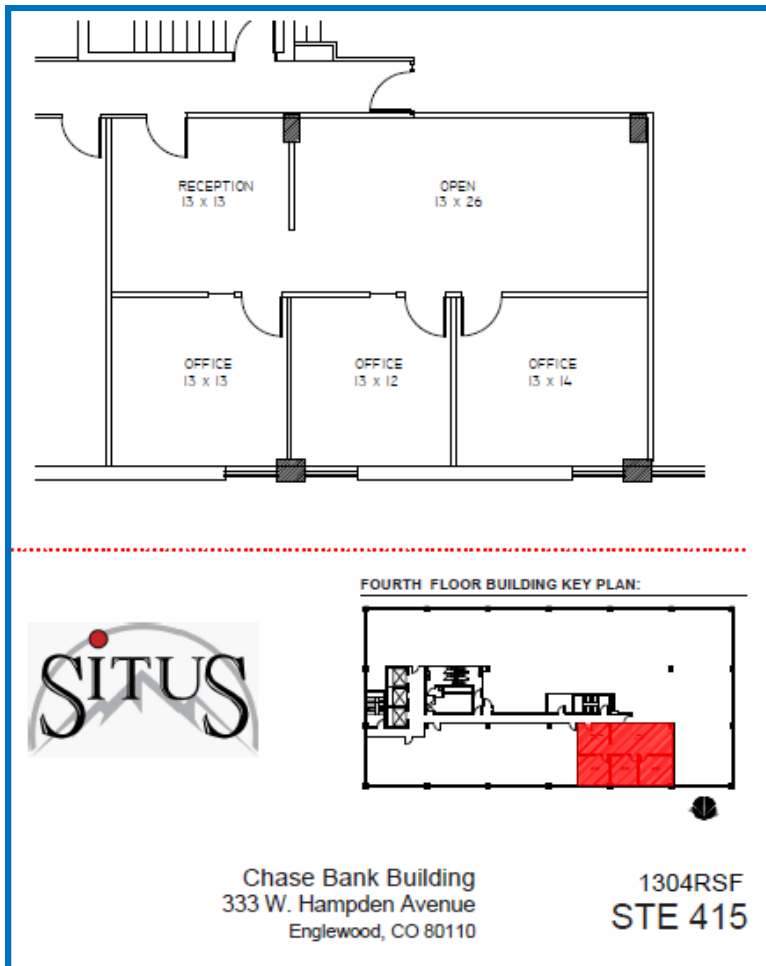

No warranty or representation is made as to the accuracy of the foregoing information.  
Terms of sale or lease and availability are subject to change or withdrawal without notice.

**FOR MORE INFORMATION, PLEASE CALL:**

**John V. Propp, CCIM—303/692-1816  
6565 S. Dayton St., Suite 3000  
Greenwood Village, CO 80111**

**learn more at [www.JohnProppCommercial.com](http://www.JohnProppCommercial.com)**



**CHASE TOWER**

333 W. HAMPDEN AVENUE  
ENGLEWOOD, CO 80110



**\$18.50—\$19.50 Full Service Rate**

**Full service lease rate—all expenses included**

**Suite 615  
742 sf**

**Two offices, reception and breakroom.**

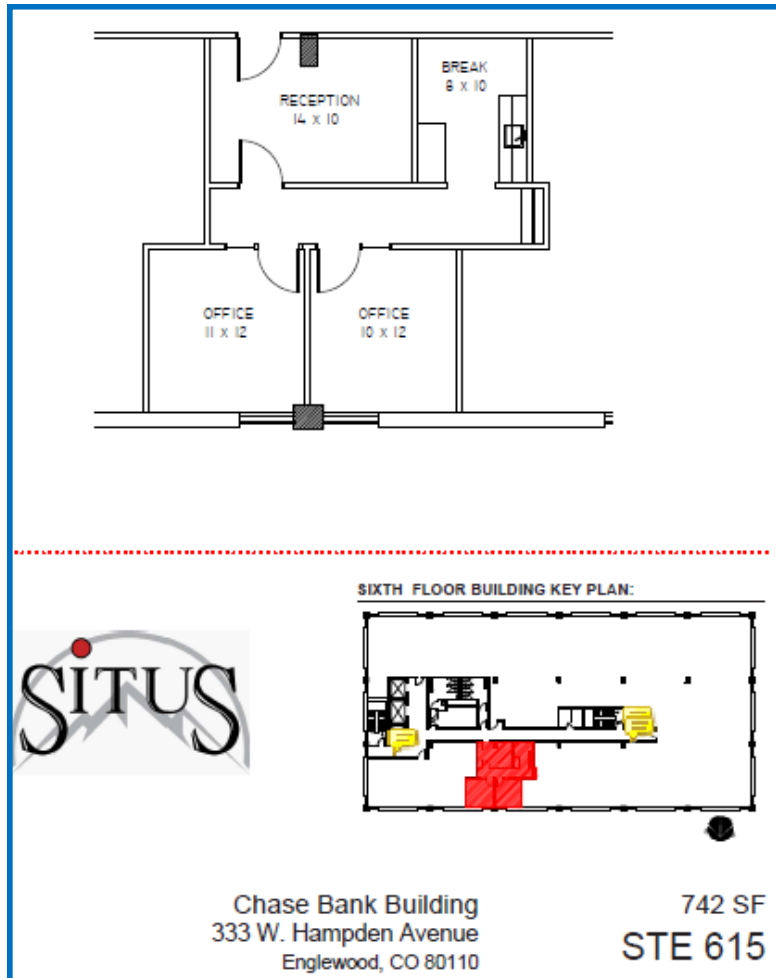

No warranty or representation is made as to the accuracy of the foregoing information.  
Terms of sale or lease and availability are subject to change or withdrawal without notice.

**FOR MORE INFORMATION, PLEASE CALL:**

**John V. Propp, CCIM—303/692-1816  
6565 S. Dayton St., Suite 3000  
Greenwood Village, CO 80111**

**learn more at [www.JohnProppCommercial.com](http://www.JohnProppCommercial.com)**



**CHASE TOWER**  
333 W. HAMPDEN AVENUE  
ENGLEWOOD, CO 80110



**\$18.50—\$19.50 Full Service Rate**

**Full service lease rate—all expenses included**

**Suite 925 (potential)  
4,642 sf**

**Suite 935  
1,785 sf**

**Plan has been built out slightly.  
Plan has been built out with five offices,  
reception, break area.**

**Can be combined for a total of 6,472 sf.**

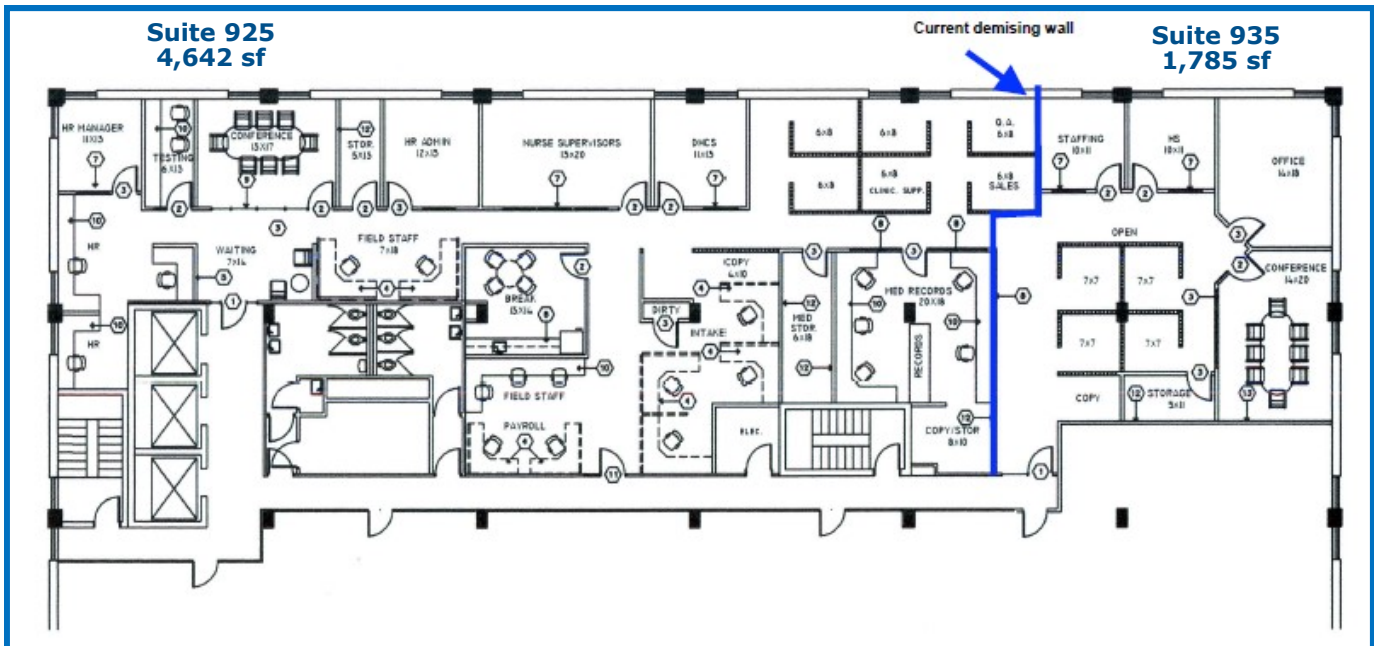

No warranty or representation is made as to the accuracy of the foregoing information.  
Terms of sale or lease and availability are subject to change or withdrawal without notice.

**FOR MORE INFORMATION, PLEASE CALL:**

**John V. Propp, CCIM—303/692-1816**  
6565 S. Dayton St., Suite 3000  
Greenwood Village, CO 80111

**learn more at [www.JohnProppCommercial.com](http://www.JohnProppCommercial.com)**



**CHASE TOWER**

333 W. HAMPDEN AVENUE  
ENGLEWOOD, CO 80110



**\$18.50—\$19.50 Full Service Rate**

**Full service lease rate—all expenses included**

**Suite 1015  
777 sf**

**Great open concept. One office  
with kitchen/bar area.**

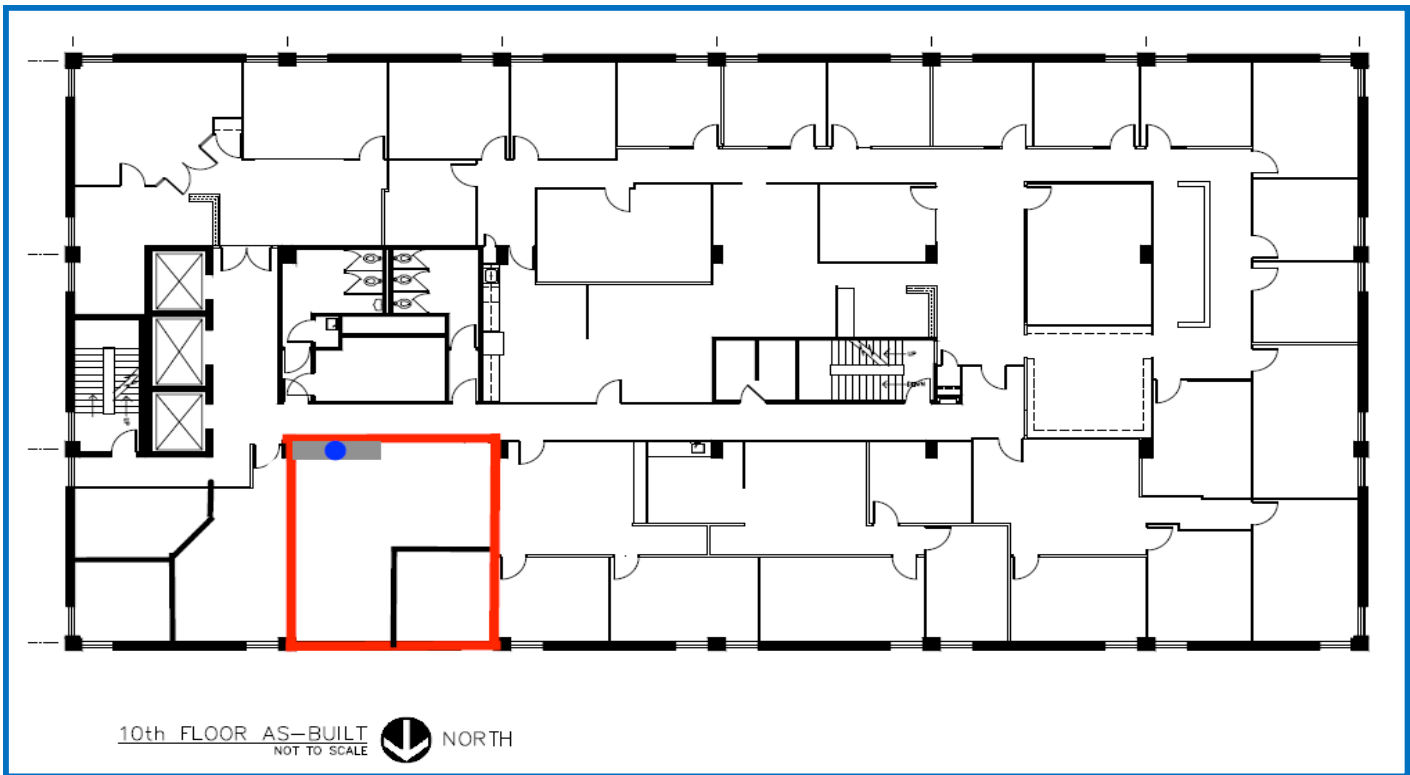

No warranty or representation is made as to the accuracy of the foregoing information.  
Terms of sale or lease and availability are subject to change or withdrawal without notice.

**FOR MORE INFORMATION, PLEASE CALL:**

**John V. Propp, CCIM—303/692-1816  
6565 S. Dayton St., Suite 3000  
Greenwood Village, CO 80111**

**learn more at [www.JohnProppCommercial.com](http://www.JohnProppCommercial.com)**

